



Multipole connectors



20 23

Newsbook

Extract 7/9



**SD SERIES 10 A
STAMPED CRIMP CONTACTS**

TECHNICAL FEATURES

Alternative (but not equivalent) to the turned crimp contacts series **CD**, for less demanding applications e.g., reduced current-carrying capacity.

Available with **silver plating** in one performance level for up to **500** mating cycles, either as loose part contacts or in 5 000-piece reels with.

Open crimp barrel contacts **without insulation grip**, providing tensile strength (pullout force) compliant with EN/IEC 60352 Ed. 2, lower than corresponding turned, closed crimp barrel contacts series CD (EN/IEC 60352-2 Ed.1.0 had two different curves A and B, later consolidated in the lower demanding curve B, whereas ILME CD turned contacts still claim conformity to curve A).

Q Compatible with connector inserts:

- series **CD**;
- series **CDD**;
- series **CQ** and **CQ4**:
CQF /M 07, CQF /M 12 (not the version CIF for interface to PCB), CQF /M 17, CQF /M 04/2, CQ4 03/2 (where underlined, auxiliary poles only);
- combined connector inserts series **CX**:
CXF /M 8/24, CXF /M 6/12, CXF /M 6/36, CXF /M 12/2, CX 1/2 BDF /M;
- series **MIXO** modules:
CX 12 DF / M, CX 17 DF /M, CX 42 DF /M, CX 3/4 XD, CX 01 BF /M (MIXO COAX), CX 04 BF /M (MIXO BUS 4P), CX 01 JF /M, CX 02 JF / M.

Q Derating diagrams of previous inserts / modules are under construction: expected to show ca. 10% less current-carrying capacity than when inserts employ corresponding turned contacts series CD.

Q Available in **2 sizes**:

- **1.0** for stranded copper wires with conductor cross-sectional area 0,37 mm² - 1 mm² (24-18 AWG);
- **2.5** for stranded copper wires with conductor cross-sectional area 1,5 mm² - 2,5 mm² (16-14 AWG).

Q Crimping tools: see page 67.

Q Removal tool: same as for series CD machined crimp contacts.

✓ CERTIFICATIONS

- cURus, CQC, DNV, BV, EAC pending.
- **CE** and **UK CA** markings.
- **RoHS**: compliant.

Widening of the ILME portfolio ►
of stamped crimp contacts with
the new **SD Series (10 A)**

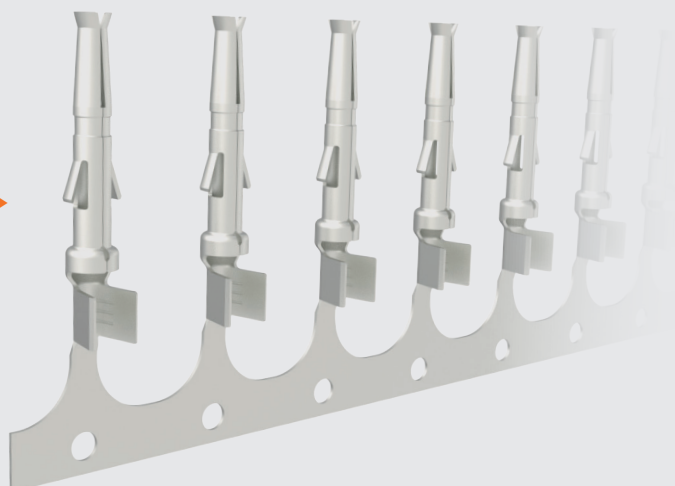



SDFA – SDMA 10 A stamped contacts

inserts:		page:	
CD	(10 A)	66 - 74	
CDD	(10 A)	76 - 83	
CQ	(10 A)	187 - 193	
CX 8/24	(16 A/10 A)	194	
CX 6/12 *	(10 A)	197	
CX 6/36 *	(10 A)	198	
CX 12/2 *	(40 A/10 A)	199	
RD (HNM)	(10 A)	208 - 209	
RDD (HNM)	(10 A)	210 - 213	
MIXO	(10 A/16 A)	271 - 306	

CQ4 03/2 *	16
CX 9/42 *	20
CX 08 D5/D5..2	44
CX 08 D5G/D5G..2	52
CQ 04/2E *	62

* the underlined polarities indicate those contacts that require the tools shown in this page

refer to CN.19 pages refer to News 2021 pages
refer to News 2020 pages

SD 10 A crimp contacts



Q STAMPED CONTACTS

FROM OCTOBER 2023

SD 10 A crimp contacts



Q STAMPED CONTACTS

FROM OCTOBER 2023

description	part No.	pcs. (1 packaging unit)	part No.	pcs. (1 packaging unit)
female stamped crimp contacts (loose parts) 0,37 mm ² - 1 mm ² AWG 24-18 1,5 mm ² - 2,5 mm ² AWG 16-14	SDFA 1.0 SDFA 2.5	200		
male stamped crimp contacts (loose parts) 0,37 mm ² - 1 mm ² AWG 24-18 1,5 mm ² - 2,5 mm ² AWG 16-14	SDMA 1.0 SDMA 2.5	200		
female stamped crimp contacts (reel package) 0,37 mm ² - 1 mm ² AWG 24-18 1,5 mm ² - 2,5 mm ² AWG 16-14	SDFA 1.0R SDFA 2.5R	5000		
male stamped crimp contacts (reel package) 0,37 mm ² - 1 mm ² AWG 24-18 1,5 mm ² - 2,5 mm ² AWG 16-14	SDMA 1.0R SDMA 2.5R	5000		

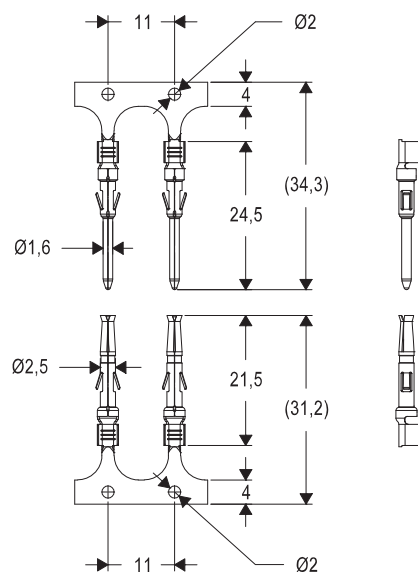
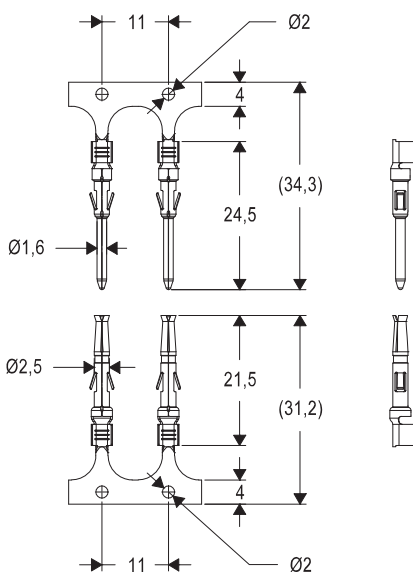

Recommended crimping tools
Loose parts: **SDPZ TP**
Reel package: suitable for stripping / crimping automated machines to be used with 5 000 pieces reels, please contact ILME S.p.A.

SDFA.. R – SDMA.. R

Reel unrolling left

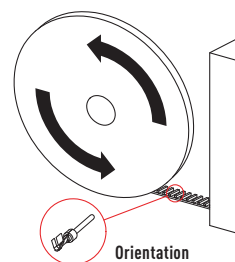



Tools and accessories for crimp contacts

for contacts of inserts series

CD	(10 A)	66 - 74
CDD	(10 A)	76 - 83
CQ	(10 A)	187 - 193
CX 8/24	(16 A/10 A)	194
CX 6/12 *	(10 A)	197
CX 6/36 *	(10 A)	198
CX 12/2 *	(40 A/10 A)	199
RD (HNM)	(10 A)	208 - 209
RDD (HNM)	(10 A)	210 - 213
MIXO	(10 A/16 A)	271 - 306

page: crimping tool



insertion tool - removal tool
replacement tip



CQ4 03/2 *		16
CX 9/42 *		20
CX 08 D5/D5..2		44
CX 08 D5G/D5G..2		52
CQ 04/2E *		62

* the underlined polarities indicate those contacts that require the tools shown in this page

refer to CN.19 pages refer to News 2021 pages
refer to News 2020 pages

description	part No.	part No.	part No.
pneumatic tool for 10 A SD contacts (for loose pcs) RENNSTEIG model PEW12 (crimping dies and turret head are included)	SDPZ TP		
removal tool for the extraction of contacts from the inserts for 10 A contacts		CCES	
replacement tip for CCES removal tool			CCPR RN



ILME S.p.A.
Via Marco Antonio Colonna, 9
20149 Milano - Italy
www.ilme.com

XDGNE23 7/9

